

Report of the Head of Planning & Enforcement Services

Address FORMER RAF EASTCOTE LIME GROVE RUISLIP

Development: S73 Application to vary the design, internal layout and external appearance of Block C (modifications of conditions 1, 6 and 10 of Reserved Matters approval ref: 10189/APP/2007/3046 dated 13/03/2008: (details of siting, design, external appearance and landscaping), in compliance with conditions 2 and 3 of outline planning permission ref: 10189/APP/2007/3383 dated 21/02/2008: Residential development).

LBH Ref Nos: 10189/APP/2012/3143

Drawing Nos: 5585/WIM.WL/M/P1 rev. B
5585/WIM.WL/L/P2
5585/WIM.WL/L/P3
5585/WIM.WL/M/E2
5585/WIM.WL/N/E1
5585/WIM.WL/N/E2
5585/WIM.WL/R/E1
5585/WIM.WL/R/E2
5585/WIM.WL/R/E3
5585/WIM.WL/R/E4
5585/WIM.WL/R/P2 A
5585/WIM.WL/R/P3 A
5585/WIM.WL/S/E1
5585/WIM.WL/S/E2
5585/WIM.WL/U/E1
5585/WIM.WL/U/E2
5585/WIM.WL/A1/E1 rev. A
5585/WIM.WL/A1/E2 rev. A
5585/WIM.WL/A1/P1 rev. A
5585/WIM.WL/A/E1 rev. B
5585/WIM.WL/A/P1 rev. B
5585/WIM.WL/A/P2 rev. B
5585/WIM.WL/A/P3 rev. B
5585/WIM.WL/A/P4 rev. B
5585/WIM.WL/B/E2 rev. A
5585/WIM.WL/ 1225/P1
5585/WIM.WL/ 1225/P2
5585/WIM.WL/ 1396C/E2
5585/WIM.WL/ 1396SP/P1
5585/WIM.WL/ 1396C/P2
5585/WIM.WL/ 1396/P1
5585/WIM.WL/ 1400+/E1
5585/WIM.WL/ 1400+P1
5585/WIM.WL/ 1402C/E2
5585/WIM.WL/ 1402C/P1
5585/WIM.WL/ 1735+/E1
5585/WIM.WL/ 1735+/P1
5585/WIM.WL/ 2000/E1
5585/WIM.WL/ 2000/E2,
5585/WIM.WL/ 2BCH/E1

5585/WIM.WL/ 2BCH/P1
5585/WIM.WL/ 3BCH/E1
5585/WIM.WL/ 3BCH/P1A
5585/WIM.WL/ 4BWC/E1
5585/WIM.WL/ 5BH/E1A
5585/WIM.WL/ 5BH/E2A
5585/WIM.WL/ 5BH/P1A
5585/WIM.WL/B/E1 rev. A
5585/WIM.WL/B/E2 rev. A
5585/WIM.WL/B/P1 rev. A
5585/WIM.WL/P/E1 rev. A
5585/WIM.WL/P/P1 REV. A
5585/WIM.WL/1089/E2 rev. A
5585/WIM.WL/1216/E1 rev. A
5585/WIM.WL/1216/E2 rev. A
5585/WIM.WL/1225/E2 rev. A
5585/WIM.WL/1396C/E1 rev. A
5585/WIM.WL/14020/E1 rev. A
5585/WIM.WL/2000/P1 rev. A
5585/WIM.WL/4BWC/P1 rev. A
5585/WIM.WL/ /E2A
5585/WIM.WL/B/E1
5585/WIM.WL/P3 A
5585/WIM.WL/1396C/E1
WWL/A/3717/BLKC/02 M - Block C First Floor Plans
WWL/A/3717/BLKC/03 N - Block C Second Floor Plans
WWL/A/3717/BLKC/06 D - Front and Side Elevation
WWL/A/3717/BLKC/07 C - Rear and Side Elevation
5585/WIM.WL/ P/P1
5585/WIM.WL/ 713/E1
5585/WIM.WL/ P/E2
5585/WIM.WL/G/E2
5585/WIM.WL/G/P1
5585/WIM.WL/G/P2
5585/WIM.WL/GIP3
5585/WIM.WL/J/E1
5585/WIM.WL/J/E2
5585/WIM.WL/ 713/P1
5585/WIM.WL/ 1089/P1
5585/WIM.WL/ 1089/P2
5585/WIM.WL/ 1216/P1
5585/WIM.WL/D/E1
5585/WIM.WL/B/P1 rev. A
5585/WIM.WL/B/P2 rev. A
5585/WIM.WL/B/P3 rev. A
5585/WIM.WL/E/E1 rev. B
5585/WIM.WL/E/E2 rev. B
5585/WIM.WL/E/P1 rev. B
5585/WIM.WL/E/P2 rev. B
5585/WIM.WL/E/P3 rev. B
5585/WIM.WL/EAA/P1

5585/WIM.WL/D/E2A
5585/WIM.WL/D/P1A
5585-WIM-WL-LOC1001
WWL/A/3717/BLKC/01 N - Block C Ground Floor Plans
5585/WIM.WL/F/E2 A
5585/WIM.WL/D/P2A
5585/WIM.WL/F/E1 A
5585/WIM.WL/EAA/P2
5585/WIM.WL/EAA/P3
5585/WIM.WL/F/P1 A
5585/WIM.WL/G/P1 rev. A
5585/WIM.WL/K/E1 rev. B
5585/WIM.WL/K/E2 rev. B
5585/WIM.WL/K/E3, rev. A
5585/WIM.WL/K/E4, rev. A
5585/WIM.WL/K/P1 rev. B
5585/WIM.WL/K/P2 rev. B
5585/WIM.WL/K/P3 rev. B
5585/WIM.WL/M/E1 rev. B
5585/WIM.WL/M/E3 rev. A
5585/WIM.WL/03
5585/WI.WL/05 A
5585/WIM.WL/M/E4 rev. A
5585/WIM.WL/F
5585/WIM.WL/R/P1 rev. B
5585/WIM.WL/S/P1 rev. A
5585/WIM.WL/U/P1 rev. A
5585/WIM.WL/U/P2 rev. A
5585/WIM.WL/U/P3 rev. A
5585/WI.WL/SS/P1
5585/WIM.WL/01 REV.C
5585/WIM.WL/02 REV.C
5585/WIM.WL/04 REV.C
5585/WIM.WL/06
5585/WIM.WL/07
5585/WIM.WL/V/E rev. A
5585/WIM.WL/V/E2 rev. A
5585/WIM.WL/V/E3 rev. A
5585/WIM.WL/V/P1 rev. A
5585/WIM.WL/V/P2 rev. A
5585/WIM.WL/V/P3 rev. A
5585/WIM.WL/GAR/P6
5585/WIM.WL/GAR/P7
5585/WIM.WL/GAR/P8
5585/WIM.WL/GAR/P9
5585/WIM.WL/CAR/P1
5585/WIM.WL/V/P4 rev. A
5585/WIM.WL/W/E1 rev. A
5585/WIM.WL/W/E2 rev. A
5585/WIM.WL/W/E3 rev. A
5585/WIM.WL/W/E4 rev. A

5585/WIM.WL/W/P1 rev. A
5585/WIM.WL/BCS/P1
5585/WIM.WL/SS/P1
5585/WIM.WL/WP0111
5585/WIM.WL/WPO2
5585/WIM.WL/3DABB/E2
5585/WIM.WL/3DAB/P1
5585/WIM.WL/W/P2 rev. A
5585/WIM.WL/W/P3 rev. A
5585/WIM.WL/H1/E2
5585/WIM.WL/H1/E3
5585/WIM.WL/106
5585/WIM.WL/107
5585/WIM.WL/3BWC/E1
5585/WIM.WL/3BWC/E2
5585/WIM.WL/3BWC/P1
5585/WIM.WL/P/E1 rev. A
5585/WIM.WL/P/E2 rev. A
5585/WIM.WL/P/E3 rev. A
5585/WIM.WL/P/E4 rev. A
5585/WIM.WL/P/P1 rev. A
5585/WIM.WL/P/P2 rev. A
5585/WIM.WL/F/P2 A
5585/WIM.WL/P/P3 rev. A
5585/WIM.WL/T/E1
5585/WIM.WL/T/E2
5585/WIM.WL/T/E3
5585/WIM.WL/T/E4
5585/WIM.WL/T/P1
5585/WIM.WL/T/P2
5585/WIM.WL/T/P3
5585/WIM.WL/DDA/P1
5585/WI.WL/SS/A
5585/WI.WL/SS/B
5585/WI.WL/SS/C
5585/WI.WL/SS/D
5585/WI.WL/GAR/P1
5585/WIM.WL/Q/E1 rev. A
5585/WIM.WL/Q/E2 rev. A
5585/WI.WL/GAR/P2
5585/WI.WL/GAR/P3
5585/WI.WL/GAR/P4
5585/WI.WL/GAR/P5
5585/WIM.WL/H1/E4
5585/WIM.WL/H1/P1
5585/WIM.WL/4BH/E1
5585/WIM.WL/4BH/E2
PDFMERE400 REV. C01
5585/WIM.WL/H1/P2
5585/WIM.WL/H2/E1
5585/WIM.WL/H2/E2

WIM16329-10C
WIM16329-11C
WIM16329- 12C
WIM16061-13
WIM160161-14B
16061-03 A
WIM 6061-09A
WIM16329- 12A
M16329-15 A, sheet 1
M16329-15 A, sheet 2
M16329-15 A, sheet 3
M16329-15 A, sheet 4
M16329-15 A, sheet 5
M16329-15 A, sheet 6
M16329-15 A, sheet 7
M16329-15 A, sheet 8
M16329-15 A, sheet 9
Planning Statement
Design and Access Statement
Tree Report
Schedule of Landscape Maintenance
Energy strategy
Noise Assessment
Flood Risk Assessment
Desktop Archaeological Study
Comments on from the Public Exhibition 16th October 2007
Arboricultural Method Statement
5585/WIM.WL/M/P4 rev. B
5585/WIM.WL/H2/E3
5585/WIM.WL/H2/P1
5585/WIM.WL/H2/P2
5585/WIM.WL/H2/P3
5585/WIM.WL/101
5585/WIM.WL/102
5585/WIM.WL/M/P2 rev. B
5585/WIM.WL/ 1225/E1
5585/WIM.WL/ 1225/E3
HG005 REV.P2
5585/WIM.WL/J/E3
5585/WIM.WL/J/P3
5585/WIM.WL/L/E1
5585/WIM.WL/L/E2
5585/WIM.WL/L/E3
5585/WIM.WL/L/P1
5585/WIM.WL/J/P1
5585/WIM.WL/J/P2
5585/WIM.WL/H1/E1
5585/WIM.WL/M/P3 rev. B
5585/WIM.WL/104
5585/WIM.WL/105
5585/WI.WL/GAR/P6

5585/WI.WL/BCS/P1
5585/WIM.WL/Q/E3 rev. A
Eco Homes Assessment
Arboricultural Implications Assessment
Habitat Survey

Date Plans Received:	19/12/2012	Date(s) of Amendment(s):	11/01/2013
Date Application Valid:	11/01/2013		02/10/2007
			03/12/2007
			09/10/2007
			30/11/2007
			04/12/2007

1. SUMMARY

The application seeks a S.73 amendment to Condition 1, 6 and 10 of Reserved Matters approval ref: 10189/APP/2007/3046 for the redevelopment of RAF Eastcote.

The application is one of five concurrent applications which seek to regularise the built development at the site, as a number of infractions have ensured the scheme has not been built in accordance with the approved plans.

This application relates to Block C of the approved scheme at RAF Eastcote in order to regularise the built development in the following areas:

- Rear Elevation (facing into the estate)- An approved roof light has been built larger than the approved plans, the developer advises that this is in order to comply with Building Regulations (fire escape). Also the dormer has been built with a break in the eaves line of the roof.
- Southern Side Elevation (facing Estate Road) - 3 new roof lights serving an approved internal habitable rooms have been inserted which were not part of the Reserved Matters Approval.
- The dormer windows on the Northern Side Elevation and Front Elevation (facing High Road) have been erected with a break in the eaves line of the roof.
- An internal alteration has been made to a second floor flat increasing this from a two bedroom to a three bedroom property, but no new units or bedrooms have been created and there is no change to building envelope.
- No change to height, footprint or massing of Block C has occurred between the approved reserved matters and the 'as built' scheme.

The completed development is considered to have had an acceptable impact on the visual amenities of the surrounding area and the character and appearance of the Eastcote Village Conservation Area. The additional rooflights in Block C are considered not to have led to a significant loss of residential amenity to any neighbouring occupier in terms of loss of privacy.

The enlarged second floor flat is provided with sufficient internal floor area and external amenity area for a three bedroom flat and the amended layout is considered accessible by wheelchair users. Therefore, the application is recommended for approval.

2. RECOMMENDATION

APPROVAL subject to the following:

1 M1 Details/Samples to be Submitted

No development shall take place until details and/or samples of all materials, colours and finishes to be used on all external surfaces have been submitted to and approved in writing by the Local Planning Authority. Such details shall include:

- * vertical tile hanging,
- * balcony railings,
- * roof details,
- * porches,
- * fenestration types and doors,
- * comprehensive colour schemes for all built details.

REASON

To ensure that the development presents a satisfactory appearance in accordance with Policy BE13 of the Hillingdon Local Plan (November 2012).

2 ST1 Standard Condition

The development hereby approved north of public footpath R154 shall not be commenced until evidence is provided to the Local Planning Authority that a Department for Environment Food and Rural Affairs (DEFRA) Licence, in respect of the protection of the population of Great Crested Newts, has been obtained.

REASON

To ensure the protection of a European Protected Species and that the proposed development will not have unacceptable ecological effects on a Nature Reserve and Nature Conservation Site of Borough Grade II importance, in accordance with Part 1 Policy EM7 of the Hillingdon Local Plan (November 2012).

3 ST1 Standard Condition

The development hereby approved shall incorporate measures to minimize the risk of crime and to meet the specific security needs of the application site and the development. Details of security measures shall be submitted and approved in writing by the Local Planning Authority before development commences. Any security measures to be implemented in compliance with this condition shall reach the standard necessary to achieve the 'Secured by Design' accreditation awarded by the Hillingdon Metropolitan Police Crime Prevention Design Adviser (CPDA) on behalf of the Association of Chief Police Officers (ACPO).

REASON

In pursuance of the Council's duty under section 17 of the Crime and Disorder Act 1998 to consider crime and disorder implications in exercising its planning functions; to promote the well being of the area in pursuance of the Council's powers under section 2 of the Local Government Act 2000, and to reflect the guidance contained in Circular 5/94 'Planning Out Crime' and the Council's SPG on Community Safety By Design.

4 ST1 Standard Condition

Notwithstanding the provisions of the Town and Country Planning (General Permitted Development) Order 1995 (or any order revoking and re-enacting that Order with or without modification), no extension to any dwellinghouse(s) including enlargement of roofs, nor any garage(s), shed(s) or other out-building(s) shall be erected without the grant of further specific permission from the local planning authority.

REASON

So that the Local Planning Authority can ensure that any such development would not result in a significant loss of residential amenity in accordance with policy BE21 of the Hillingdon Local Plan (November 2012).

5 ST1 Standard Condition

No development shall take place until details of the height, position, design and materials of any chimney or extraction vent or flue to be provided in connection with the Bio Mass boilers have been submitted to and approved in writing by the Local Planning Authority. The development shall not be occupied until the vent/flue or chimney has been installed in accordance with the approved details. Thereafter it shall be permanently retained and maintained in good working order for so long as the use continues.

REASON

In order to safeguard the amenities of adjoining properties in accordance with Policy OE1 of the Hillingdon Local Plan (November 2012).

6 ST1 Standard Condition

Notwithstanding the provisions of the Town and Country Planning (General Permitted Development) Order 1995 (or any order revoking and re-enacting that Order with or without modification), no additional windows or doors shall be constructed in the walls or roof slopes of any of the residential units hereby approved.

REASON

To prevent overlooking to adjoining properties in accordance with policy BE24 of the Hillingdon Local Plan (November 2012).

7 ST1 Standard Condition

The first and/or second floor side windows of all dwelling houses shall be glazed with obscured glass and non-opening except at top vent level for so long as the development remains in existence.

REASON

To prevent overlooking to adjoining properties in accordance with policy BE24 of the Local Plan (November 2012).

8 DIS2 Access to Buildings for People with Disabilities

Development shall not commence until details of access to building entrances (to include ramped/level approaches, signposting, types and dimensions of door width and lobby openings) to meet the needs of people with disabilities have been submitted to and approved in writing by the Local Planning Authority. The approved facilities should be provided prior to the occupation of the development and shall be permanently retained thereafter.

REASON

To ensure that people with disabilities have adequate access to the development in accordance with Policies AM13 and R16 of the Hillingdon Local Plan (November 2012) and Policies 3.5 & 3.8 and 7.2 of the London Plan (July 2011).

9 DIS3 Parking for Wheelchair Disabled People

Development shall not commence until details of parking provision for wheelchair disabled people, have been submitted to and approved in writing by the Local Planning Authority. The development shall not be occupied until all the approved details have been

implemented and thereafter these facilities shall be permanently retained.

REASON

To ensure that people in wheelchairs are provided with adequate car parking and convenient access to building entrances in accordance with policy AM13 of the Hillingdon Local Plan (November 2012).

10 ST1 Standard Condition

Details of the internal design of the wheelchair units and the compliance of the remaining units to lifetime homes standard shall be submitted to and approved in writing by the Local Planning Authority before development commences. Hereafter, the units shall be constructed in accordance with the approved details.

REASON

To ensure that sufficient housing stock is provided to meet the needs of people with disabilities and the elderly in accordance with Policy 3.8 of the London Plan (July 2011) and the Hillingdon Design and Accessibility Statement (HDAS) 'Accessible Hillingdon'.

11 T3 Time Limit - Tree Works

Development shall be commenced until the fencing to protect the entire root areas/crown spread of trees, hedges and other vegetation to be retained has been erected in accordance with the details in the approved Arboricultural Impact Appraisal, approved Method Statement and Tree Protection Plan. The fencing shall be retained in position until development is completed. The area within the approved protective fencing shall remain undisturbed during the course of the works and in particular in these areas.

REASON

To enable the Local Planning Authority to reconsider the appropriateness of the works in the light of possible changed circumstances.

12 TL5 Landscaping Scheme - (full apps where details are reserved)

Details of the supervision of the tree protection referred to in the approved Method Statement received on 4/12/2007, in relation to the approved development, together with a programme of arboricultural input / works shall be submitted to and approved in writing by the Local Planning Authority prior to the development commencing. The scheme should be carried out in accordance with the approved method statement.

REASON

To ensure that the proposed development will preserve and enhance the visual amenities of the locality in compliance with policy BE38 of the Hillingdon Local Plan (November 2012).

INFORMATIVES

1 I52 Compulsory Informative (1)

The decision to GRANT planning permission has been taken having regard to all relevant planning legislation, regulations, guidance, circulars and Council policies, including The Human Rights Act (1998) (HRA 1998) which makes it unlawful for the Council to act incompatibly with Convention rights, specifically Article 6 (right to a fair hearing); Article 8 (right to respect for private and family life); Article 1 of the First Protocol (protection of property) and Article 14 (prohibition of discrimination).

2 I53 Compulsory Informative (2)

The decision to GRANT planning permission has been taken having regard to the policies and proposals in the Hillingdon Unitary Development Plan Saved Policies (September 2007) set out below, including Supplementary Planning Guidance, and to all relevant material considerations, including the London Plan (July 2011) and national guidance.

AM2	Development proposals - assessment of traffic generation, impact on congestion and public transport availability and capacity
AM7	Consideration of traffic generated by proposed developments.
AM8	Priority consideration to pedestrians in the design and implementation of road construction and traffic management schemes
AM9	Provision of cycle routes, consideration of cyclists' needs in design of highway improvement schemes, provision of cycle parking facilities
AM13	AM13 Increasing the ease of movement for frail and elderly people and people with disabilities in development schemes through (where appropriate): - (i) Dial-a-ride and mobility bus services (ii) Shopmobility schemes (iii) Convenient parking spaces (iv) Design of road, footway, parking and pedestrian and street furniture schemes
AM14	New development and car parking standards.
BE4	New development within or on the fringes of conservation areas
BE13	New development must harmonise with the existing street scene.
BE15	Alterations and extensions to existing buildings
BE19	New development must improve or complement the character of the area.
BE20	Daylight and sunlight considerations.
BE21	Siting, bulk and proximity of new buildings/extensions.
BE22	Residential extensions/buildings of two or more storeys.
BE23	Requires the provision of adequate amenity space.
BE24	Requires new development to ensure adequate levels of privacy to neighbours.
BE38	Retention of topographical and landscape features and provision of new planting and landscaping in development proposals.
H4	Mix of housing units
H5	Dwellings suitable for large families
OE1	Protection of the character and amenities of surrounding properties and the local area
R16	Accessibility for elderly people, people with disabilities, women and children
R17	Use of planning obligations to supplement the provision of recreation, leisure and community facilities
LPP 3.4	(2011) Optimising housing potential
LPP 3.5	(2011) Quality and design of housing developments
LPP 3.8	(2011) Housing Choice
LPP 5.1	(2011) Climate Change Mitigation
LPP 5.2	(2011) Minimising Carbon Dioxide Emissions
LPP 5.3	(2011) Sustainable design and construction

LPP 5.7	(2011) Renewable energy
LPP 5.12	(2011) Flood risk management
LPP 5.13	(2011) Sustainable drainage
LPP 6.9	(2011) Cycling
LPP 6.13	(2011) Parking
LPP 7.1	(2011) Building London's neighbourhoods and communities
LPP 7.2	(2011) An inclusive environment
LPP 7.3	(2011) Designing out crime
LPP 7.4	(2011) Local character
LPP 7.6	(2011) Architecture
HDAS-LAY	Residential Layouts, Hillingdon Design & Access Statement, Supplementary Planning Document, adopted July 2006
LDF-AH	Accessible Hillingdon , Local Development Framework, Supplementary Planning Document, adopted January 2010
SPD-PO	Planning Obligations Supplementary Planning Document, adopted July 2008

3 159 Councils Local Plan : Part 1 - Strategic Policies

On this decision notice policies from the Councils Local Plan: Part 1 - Strategic Policies appear first, then relevant saved policies (referred to as policies from the Hillingdon Unitary Development Plan - Saved Policies September 2007), then London Plan Policies.

On the 8th November 2012 Hillingdon's Full Council agreed the adoption of the Councils Local Plan: Part 1 - Strategic Policies. Appendix 5 of this explains which saved policies from the old Unitary Development (which was subject to a direction from Secretary of State in September 2007 agreeing that the policies were 'saved') still apply for development control decisions.

4

Your attention is drawn to conditions 1, 2, 5, 9, 10, 11 & 12 which have been discharged under applications 10189/APP/2008/2800, 10189/APP/2008/2872, 10189/APP/2009/1845, 10189/APP/2010/1336, 10189/APP/2008/1941 and 100189/APP/2008/2380 and no further information is required in relation to these conditions. However condition 3 is still required to be discharged. The Council may consider taking enforcement action to rectify the breach of any condition(s). For further information and advice contact - Planning & Community Services, Civic Centre, Uxbridge, UB8 1UW (Tel: 01895 250230).

5 11 Building to Approved Drawing

You are advised this permission is based on the dimensions provided on the approved drawings as numbered above. The development hereby approved must be constructed precisely in accordance with the approved drawings. Any deviation from these drawings requires the written consent of the Local Planning Authority.

6 12 Encroachment

You are advised that if any part of the development hereby permitted encroaches by either its roof, walls, eaves, gutters, or foundations, then a new planning application will have to be submitted. This planning permission is not valid for a development that results in any form of encroachment.

7 13 Building Regulations - Demolition and Building Works

Your attention is drawn to the need to comply with the relevant provisions of the Building Regulations, the Building Acts and other related legislation. These cover such works as -

the demolition of existing buildings, the erection of a new building or structure, the extension or alteration to a building, change of use of buildings, installation of services, underpinning works, and fire safety/means of escape works. Notice of intention to demolish existing buildings must be given to the Council's Building Control Service at least 6 weeks before work starts. A completed application form together with detailed plans must be submitted for approval before any building work is commenced. For further information and advice, contact - Planning & Community Services, Building Control, 3N/01 Civic Centre, Uxbridge (Telephone 01895 250804 / 805 / 808).

8

There is need for the archaeological potential of the site to be further clarified through field evaluation, which is in accordance with Condition 32 of the approved outline permission. This will take the form of trial trenches across the site, but concentrated in the southwest corner. A Written Scheme of Investigation will need to be submitted and approved prior to the commencement of the evaluation works.

9 16 Property Rights/Rights of Light

Your attention is drawn to the fact that the planning permission does not override property rights and any ancient rights of light that may exist. This permission does not empower you to enter onto land not in your ownership without the specific consent of the owner. If you require further information or advice, you should consult a solicitor.

10 111 The Construction (Design and Management) Regulations 1994

The development hereby approved may be subject to the Construction (Design and Management) Regulations 1994, which govern health and safety through all stages of a construction project. The regulations require clients (ie. those, including developers, who commission construction projects) to appoint a planning supervisor and principal contractor who are competent and adequately resourced to carry out their health and safety responsibilities. Further information is available from the Health and Safety Executive, Rose Court, 2 Southwark Bridge Road, London, SE1 9HS (telephone 020 7556 2100).

11 112 Notification to Building Contractors

The applicant/developer should ensure that the site constructor receives copies of all drawings approved and conditions/informatives attached to this planning permission. During building construction the name, address and telephone number of the contractor (including an emergency telephone number) should be clearly displayed on a hoarding visible from outside the site.

12 113 Asbestos Removal

Demolition and removal of any material containing asbestos must be carried out in accordance with guidance from the Health and Safety Executive and the Council's Environmental Services. For advice and information contact: - Environmental Protection Unit, 3S/02, Civic Centre, High Street, Uxbridge, UB8 1UW (Tel. 01895 277401) or the Health and Safety Executive, Rose Court, 2 Southwark Bridge Road, London, SE1 9HS (Tel. 020 7556 2100).

13 114 Installation of Plant and Machinery

The Council's Commercial Premises Section and Building Control Services should be consulted regarding any of the following:-
The installation of a boiler with a rating of 55,000 - 1¼ million Btu/hr and/or the

construction of a chimney serving a furnace with a minimum rating of 1¼ million Btu/hr;
The siting of any external machinery (eg air conditioning);
The installation of additional plant/machinery or replacement of existing machinery.
Contact:- Commercial Premises Section, 4W/04, Civic Centre, High Street, Uxbridge, UB8 1UW (Tel. 01895 250190). Building Control Services, 3N/01, Civic Centre, High Street, Uxbridge, UB8 1UW (tel. 01895 250804 / 805 / 808).

14 I15 Control of Environmental Nuisance from Construction Work

Nuisance from demolition and construction works is subject to control under The Control of Pollution Act 1974, the Clean Air Acts and other related legislation. In particular, you should ensure that the following are complied with: -

A) Demolition and construction works should only be carried out between the hours of 08.00 hours and 18.00 hours Monday to Friday and between the hours of 08.00 hours and 13.00 hours on Saturday. No works shall be carried out on Sundays or Bank Holidays.

B) All noise generated during such works should be controlled in compliance with British Standard Code of Practice BS 5228: 1984.

C) The elimination of the release of dust or odours that could create a public health nuisance.

D) No bonfires that create dark smoke or nuisance to local residents.

You are advised to consult the Council's Environmental Protection Unit, 3S/02, Civic Centre, High Street, Uxbridge, UB8 1UW (Tel. 01895 277401) or to seek prior approval under Section 61 of the Control of Pollution Act if you anticipate any difficulty in carrying out construction other than within the normal working hours set out in (A) above, and by means that would minimise disturbance to adjoining premises.

15 I18 Storage and Collection of Refuse

The Council's Waste Service should be consulted about refuse storage and collection arrangements. Details of proposals should be included on submitted plans.

For further information and advice, contact - the Waste Service Manager, Central Depot - Block A, Harlington Road Depot, 128 Harlington Road, Hillingdon, Middlesex, UB8 3EU (Tel. 01895 277505 / 506).

16 I19 Sewerage Connections, Water Pollution etc.

You should contact Thames Water Utilities and the Council's Building Control Service regarding any proposed connection to a public sewer or any other possible impact that the development could have on local foul or surface water sewers, including building over a public sewer. Contact: - The Waste Water Business Manager, Thames Water Utilities plc, Kew Business Centre, Kew Bridge Road, Brentford, Middlesex, TW8 0EE.

Building Control Service - 3N/01, Civic Centre, High Street, Uxbridge, UB8 1UW (tel. 01895 250804 / 805 / 808).

17 I24 Works affecting the Public Highway - General

A licence must be obtained from the Highway Authority before any works are carried out on any footway, carriageway, verge or other land forming part of the public highway. This includes the erection of temporary scaffolding, hoarding or other apparatus in connection with the development for which planning permission is hereby granted. For

further information and advice contact: - Highways Maintenance Operations, 4W/07, Civic Centre, Uxbridge, UB8 1UW

18

In order to check that the proposed storm water system meets their requirements, the Environment Agency will require the following information be provided to discharge condition 34 of the outline planning permission: a) A clearly labelled drainage layout plan showing pipe networks and any attenuation ponds, soakaways and drainage storage tanks. This plan should show any pipe 'node numbers' that have been referred to in network calculations and it should also show invert and cover levels of manholes. b) Confirmation of the critical storm duration. c) Where infiltration forms part of the proposed stormwater system such as infiltration trenches and soakaways, soakage test results and test locations are to be submitted in accordance with BRE digest 365. d) Where on site attenuation is achieved through attenuation ponds or tanks, calculations showing the volume of these are also required. e) Where an outfall discharge control device is to be used such as a hydrobrake or twin orifice, this should be shown on the plan with the rate of discharge stated. f) Calculations should demonstrate how the system operates during a 1 in 100 year critical duration storm event. If overland flooding occurs in this event, a plan should also be submitted detailing the location of overland flow paths.

19 134 **Building Regulations 'Access to and use of buildings'**

Compliance with Building Regulations 'Access to and use of buildings' and Disability Discrimination Act 1995 for commercial and residential development.

You are advised that the scheme is required to comply with either:-

- The Building Regulations 2000 Approved Document Part M 'Access to and use of buildings', or with
- BS 8300:2001 Design of buildings and their approaches to meet the needs of disabled people - Code of practice. AMD 15617 2005, AMD 15982 2005.

These documents (which are for guidance) set minimum standards to allow residents, workers and visitors, regardless of disability, age or gender, to gain access to and within buildings, and to use their facilities and sanitary conveniences.

You may also be required make provisions to comply with the Disability Discrimination Act 1995. The Act gives disabled people various rights. Under the Act it is unlawful for employers and persons who provide services to members of the public to discriminate against disabled people by treating them less favourably for any reason related to their disability, or by failing to comply with a duty to provide reasonable adjustments. This duty can require the removal or modification of physical features of buildings provided it is reasonable.

The duty to make reasonable adjustments can be effected by the Building Regulation compliance. For compliance with the DDA please refer to the following guidance: -

- The Disability Discrimination Act 1995. Available to download from www.opsi.gov.uk
- Disability Rights Commission (DRC) Access statements. Achieving an inclusive environment by ensuring continuity throughout the planning, design and management of building and spaces, 2004. Available to download from www.drc-gb.org.

· Code of practice. Rights of access. Goods, facilities, services and premises. Disability discrimination act 1995, 2002. ISBN 0 11702 860 6. Available to download from www.drc-gb.org.

· Creating an inclusive environment, 2003 & 2004 - What it means to you. A guide for service providers, 2003. Available to download from www.drc-gb.org.

This is not a comprehensive list of Building Regulations legislation. For further information you should contact Building Control on 01895 250804/5/6.

20

Your attention is drawn to the fact that planning permission does not override any legislation designed to protect European Protected Species, including The Conservation (Natural Habitats etc) Regulations 1994. You should contact Natural England (Tel: 020 7831 6922) if you require further information.

21 I25 **Consent for the Display of Adverts and Illuminated Signs**

This permission does not authorise the display of advertisements or signs, separate consent for which may be required under the Town and Country Planning (Control of Advertisements) Regulations 1992. [To display an advertisement without the necessary consent is an offence that can lead to prosecution]. For further information and advice, contact - Planning & Community Services, 3N/04, Civic Centre, High Street, Uxbridge, UB8 1UW (Tel. 01895 250574).

22

To promote the development of sustainable building design, you are encouraged to investigate the use of renewable energy resources which do not produce any extra carbon dioxide (CO₂) emissions, such as solar, geothermal and fuel cell systems.

23

Your attention is drawn to the fact that planning permission does not override any legislation designed to protect European Protected Species, including The Conservation (Natural Habitats etc) Regulations 1994. You should contact English Nature (Tel: 020 7831 6922) if you require further information.

24

You are advised that care should be taken during the building works hereby approved to avoid spillage of mud, soil or related building materials onto the pavement or public highway. You are further advised that failure to take appropriate steps to avoid spillage or adequately clear it away could result in action being taken under the Highways Acts.

25

Specific security needs identified for the application site include the following:

* The whole development must achieve Secured by Design (SBD) Accreditation. SBD can not be granted for the affordable housing element only.

* Pedestrian link to Azalea Walk CCTV coverage of this pedestrian link would constitute a means of control.

* Improvements to East/West Public Footpath formal surveillance by CCTV cameras and perimeter treatments of both sides of the public footpath. The requirements of SBD New Homes - Footpath Design to be closely followed where ever possible. Break-speed barriers should be installed at various points along the footpath, particularly where the CCTV cameras are trained. The perimeter treatments of the footpath should be,

wherever possible, of a robust (15 to 20mm diam round bar) park-style railings, to maximise vision both in and out. Where there is a need for 1.8m close board privacy fencing (at the rear & side of plots 82 to 100) this should be topped with an extra 200mm of (flimsy) trellis and protected from graffiti with defensive planting.

* Doors and Windows : Recessed front doors well beyond 600mm or secluded in other ways may preclude granting the SBD Award. All external (front and back) doors must be to PAS24 Standard and accessible windows to BS 7950, with the correct glassing in the appropriate areas.

* Car Parking areas: All car parking areas must meet Safer Parking Standards. All basement parking must have access control and CCTV. Any parking areas to the rear of houses should also be access controlled for those residents only. Where there are a number of vehicles using an access controlled parking area a locally recorded CCTV system should be considered

* Bin and bike stores for blocks : Wherever possible these should be within the shell of buildings. Double leaf doors should be avoided on bin stores and 'empty space' within the bin stores kept to a minimum. Bike stores to have a Pass24 standard door and racks inside broken up into cages of 2 bikes maximum - these stores must be fit for purpose. No signs outside saying 'Bicycle Store'. All Designs and security details for bike stores to be submitted before being built. No bike or bin stores to block sight lines to front doors and car parking areas etc. and wherever possible should be located within the 'private' areas of blocks of flats ie not in the public space.

* Alleys leading to the rear of houses: These must be gated flush with the front building line of the houses. Gates should have stout frames capable of housing a BS3621 mortise lock and capable of being locked/unlocked from both sides. Likewise with gates to rear gardens. Flimsy C/B gates with inadequate locks and hinges are not acceptable.

* Isolated Sub Stations : Any sub stations on the site should be well protected with 1.8m high railings, standing off at least 1.5m from the building itself. The proposed new sub station in the north of the site should not allow access behind it.

* Ambiguous ownership of land : There must be no ambiguity of ownership of any land near buildings.

* Security and CCTV around the Community Hall and LEAP. The LEAP should have railings around the perimeter as well as the play area itself and it's play equipment should be covered by CCTV. The hall itself should have good CCTV coverage all around it. You are advised to submit details to expedite the specified security needs in order to comply with Condition 3 of this planning permission. In addition to the above, and for this site to achieve 'Secured by Design' accreditation, doors and windows should also comply with the specifications set out in the 'SBD New Homes' documentation in the Design Guides & Publications section of the www.securedbydesign.com website. Consultation with the local Police Crime Prevention Design Adviser (CPDA) will be required to achieve this award. The CPDA's contact number is 0208 246 1769.

3. CONSIDERATIONS

3.1 Site and Locality

The application relates to Block C, located in the north western corner of the northern section of the former RAF Eastcote site. The three storey block has a roughly square footprint with a crown roof design and accommodation in the loft space. The reserved matters approval for the development granted 7 x 2 bedroom flats and 2 x 1 bedroom flats within Block C. The building has been completed and some of the flats within the block are occupied.

To the northeast of Block C is the highway of High Road and to the northwest are residential dwellings Nos. 1 - 3 New Cottages. The larger site is 7.7 hectares in area and is bisected into northern and southern areas by an existing public footpath.

3.2 Proposed Scheme

The application seeks to vary Condition 1 (Sample Materials), Condition 6 (Removal of PD Rights for windows and doors) and Condition 10 (Lifetime Homes Standard) to regularise Block C as the development after a number of minor infractions have ensured the scheme has not been built in accordance with the approved plans.

The required amendments are as follows:

- Rear Elevation (facing into the estate)- An approved roof light has been built larger than the approved plans, the developer advises that this is in order to comply with Building Regulations (fire escape). Also the dormer has been built with a break in the eaves line of the roof.
- Southern Side Elevation (facing Estate Road) - 3 new roof lights serving an approved internal habitable rooms have been inserted which were not part of the Reserved Matters Approval.
- The dormer windows on the Northern Side Elevation and Front Elevation (facing High Road) have been erected with a break in the eaves line of the roof.
- An internal alteration has been made to a second floor flat increasing this from a two bedroom to a three bedroom property, but no new units or bedrooms have been created and there is no change to building envelope.
- No change to height, footprint or massing of Block C has occurred between the approved reserved matters and the 'as built' scheme.

3.3 Relevant Planning History

10189/APP/2007/2463 Raf Eastcote Lime Grove Ruislip

RESERVED MATTERS (DETAILS OF SITING, DESIGN, EXTERNAL APPEARANCE AND LANDSCAPING) FOR ERECTION OF 385 RESIDENTIAL UNITS IN COMPLIANCE WITH CONDITION 2 TOGETHER WITH DETAILS OF RESIDENTIAL DENSITY, COMMUNITY FACILITY, SUSTAINABILITY AND ENERGY ASSESSMENT, REFUSE AND RECYCLING STORAGE, SITE SURVEY PLAN, LANDSCAPING, FLOOD RISK ASSESSMENT, SURFACE WATER SOURCE CONTROL MEASURES AND ACCESS STATEMENT IN COMPLIANCE WITH CONDITIONS 7, 11, 14, 19, 20, 21, 23, 26, 33, 34 & 37 OF OUTLINE PLANNING PERMISSION REF: 10189/APP/2007/3383 DATED 21/02/08 'REDEVELOPMENT OF SITE FOR RESIDENTIAL PURPOSES, COMMUNITY FACILITIES, OPEN SPACE AND ASSOCIATED PARKING AND LANDSCAPING'

Decision: 31-03-2008 Approved

10189/APP/2007/3046 Raf Eastcote Lime Grove Ruislip

RESERVED MATTERS (DETAILS OF SITING, DESIGN, EXTERNAL APPEARANCE AND LANDSCAPING) FOR ERECTION OF 385 RESIDENTIAL UNITS IN COMPLIANCE WITH CONDITION 2 TOGETHER WITH DETAILS OF RESIDENTIAL DENSITY, COMMUNITY FACILITY, SUSTAINABILITY AND ENERGY ASSESSMENT, REFUSE AND RECYCLING STORAGE, SITE SURVEY PLAN, LANDSCAPING, FLOOD RISK ASSESSMENT, SURFACE WATER CONTROL MEASURES AND ACCESS STATEMENT IN COMPLIANCE WITH CONDITIONS 7, 11, 14, 19, 20, 21, 23, 26, 33, 34 & 37 OF OUTLINE PLANNING PERMISSION REF: 10189/APP/2007/3383 DATED 21/02/08 'REDEVELOPMENT OF SITE FOR RESIDENTIAL PURPOSES, COMMUNITY FACILITIES, OPEN SPACE AND

ASSOCIATED PARKING AND LANDSCAPING'

Decision: 31-03-2008 Approved

10189/APP/2008/2699 Raf Eastcote Lime Grove Ruislip

Provision of optional conservatories to Plot 17 (Application to vary parts of the approved layout under reserved matters approval ref.10189/APP/ 2007/3046 dated 31/03/2008) (Details of siting, design, external appearance and landscaping in compliance with condition 2 of outline planning permission ref.10189/APP/2007/3383 dated 21/02/2008 'Redevelopment of site for residential purposes, community facilities, open space and associated parking and landscaping'.)

Decision: 07-11-2008 Refused

10189/APP/2008/2702 Raf Eastcote Lime Grove Ruislip

PROVISION OF OPTIONAL CONSERVATORY TO PLOT 13 (APPLICATION TO VARY PART OF THE APPROVED LAYOUT UNDER RESERVED MATTERS APPROVAL REF.10189/APP/ 2007/3046 DATED 13/03/2008) (DETAILS OF SITING, DESIGN, EXTERNAL APPEARANCE AND LANDSCAPING IN COMPLIANCE WITH CONDITION 2 OF OUTLINE PLANNING PERMISSION REF.10189/APP/2007/3383 DATED 21/02/2008 'REDEVELOPMENT OF SITE FOR RESIDENTIAL PURPOSES, COMMUNITY FACILITIES, OPEN SPACE AND ASSOCIATED PARKING AND LANDSCAPING'.)

Decision: 26-11-2008 Approved

10189/APP/2008/2703 Raf Eastcote Lime Grove Ruislip

Provision of optional conservatories to Plot 24 (Application to vary parts of the approved layout under reserved matters approval ref.10189/APP/ 2007/3046 dated 31/03/2008) (Details of siting, design, external appearance and landscaping in compliance with condition 2 of outline planning permission ref.10189/APP/2007/3383 dated 21/02/2008 'Redevelopment of site for residential purposes, community facilities, open space and associated parking and landscaping'.)

Decision: 07-11-2008 Refused

10189/APP/2008/2704 Raf Eastcote Lime Grove Ruislip

Provision of optional conservatories to Plot 83 (Application to vary parts of the approved layout under reserved matters approval ref.10189/APP/ 2007/3046 dated 31/03/2008) (Details of siting, design, external appearance and landscaping in compliance with condition 2 of outline planning permission ref.10189/APP/2007/3383 dated 21/02/2008 'Redevelopment of site for residential purposes, community facilities, open space and associated parking and landscaping'.)

Decision: 07-11-2008 Refused

10189/APP/2008/2706 Raf Eastcote Lime Grove Ruislip

PROVISION OF OPTIONAL CONSERVATORY TO PLOT 84 (APPLICATION TO VARY PART OF THE APPROVED LAYOUT UNDER RESERVED MATTERS APPROVAL REF.10189/APP/ 2007/3046 DATED 13/03/2008) (DETAILS OF SITING, DESIGN, EXTERNAL APPEARANCE

AND LANDSCAPING IN COMPLIANCE WITH CONDITION 2 OF OUTLINE PLANNING PERMISSION REF.10189/APP/2007/3383 DATED 21/02/2008 'REDEVELOPMENT OF SITE FOR RESIDENTIAL PURPOSES, COMMUNITY FACILITIES, OPEN SPACE AND ASSOCIATED PARKING AND LANDSCAPING'.)

Decision: 26-11-2008 Approved

10189/APP/2008/2708 Raf Eastcote Lime Grove Ruislip

Provision of optional conservatories to Plots 147, 148 and 149 (Application to vary parts of the approved layout under reserved matters approval ref. 10189/APP/2007/3046 dated 31/03/2008) (Details of siting, design, external appearance and landscaping in compliance with condition 2 of outline planning permission ref.10189/APP/2007/3383 dated 21/02/2008 'Redevelopment of site for residential purposes, community facilities, open space and associated parking and landscaping'.)

Decision: 12-11-2008 Refused

10189/APP/2008/2709 Raf Eastcote Lime Grove Ruislip

Provision of optional conservatories to Plots 7 and 82 (Application to vary parts of the approved layout under reserved matters approval ref.10189/APP/ 2007/3046 dated 31/03/2008) (Details of siting, design, external appearance and landscaping in compliance with condition 2 of outline planning permission ref.10189/APP/2007/3383 dated 21/2/2008 'Redevelopment of site for residential purposes, community facilities, open space and associated parking and landscaping'.)

Decision: 07-11-2008 Refused

10189/APP/2008/2711 Raf Eastcote Lime Grove Ruislip

Provision of optional conservatories to Plots 132, 133 and 134 (Application to vary parts of the approved layout under reserved matters approval ref. 10189/APP/2007/3046 dated 31/03/2008) (Details of siting, design, external appearance and landscaping in compliance with condition 2 of outline planning permission ref.10189/APP/2007/3383 dated 21/2/2008 'Redevelopment of site for residential purposes, community facilities, open space and associated parking and landscaping'.)

Decision: 07-11-2008 Refused

10189/APP/2008/2712 Raf Eastcote Lime Grove Ruislip

PROVISION OF OPTIONAL CONSERVATORIES TO PLOTS 3, 5, 90, 91, 92, 126, 127, 128, 130, 181, 182, 195, 196, 197, 198, 299 AND 300 (APPLICATION TO VARY PARTS OF THE APPROVED LAYOUT UNDER RESERVED MATTERS APPROVAL REF.10189/APP/ 2007/3046 DATED 13/03/2008) (DETAILS OF SITING, DESIGN, EXTERNAL APPEARANCE AND LANDSCAPING IN COMPLIANCE WITH CONDITION 2 OF OUTLINE PLANNING PERMISSION REF.10189/APP/2007/3383 DATED 21/02/2008 'REDEVELOPMENT OF SITE FOR RESIDENTIAL PURPOSES, COMMUNITY FACILITIES, OPEN SPACE AND ASSOCIATED PARKING AND LANDSCAPING'.)

Decision: 26-11-2008 Approved

10189/APP/2010/1976 Raf Eastcote Lime Grove Ruislip

Erection of timber sheds in the rear garden of Nos. 1, 5, 11, 13, 15, 40-48 (evens), and 52-104 (evens) Coleridge Drive, and 38 and 40 Flowers Avenue, as well as Plots 60-63, 82-86, 129, 132-134, 147-149, 184, 236-239 and 253-258 (Part retrospective application.)

Decision: 18-03-2011 Approved

10189/APP/2010/736 Raf Eastcote Lime Grove Ruislip

Provision of glazed conservatories to Plots 338, 344, 345 and 349 (Application to vary parts of the approved layout under Reserved Matters approval ref:10189/APP/2007/3046 dated 13/03/2008) (Details of siting, design external appearance and landscaping in compliance with Condition 2 of Planning Permission ref:10189/APP/2007/3383 dated 21/02/2008: Residential Development.)

Decision: 22-06-2010 Approved

10189/APP/2010/737 Raf Eastcote Lime Grove Ruislip

Provision of glazed conservatories to Plots 262, 265, 278-282 (Application to vary parts of the approved layout under Reserved Matters approval ref:10189/APP/2007/3046 dated 13/03/2008) (Details of siting, design, external appearance and landscaping in compliance with condition 2 of outline planning permission ref:10189/APP/2007/ 3383 dated 21/02/2008: ResidentialDevelopment.)

Decision: 22-06-2010 Approved

10189/APP/2011/1119 Raf Eastcote Lime Grove Ruislip

Erection of a glazed conservatory at Plot 296. (Amendment to reserved matters approval ref: 10189/APP/2007/3046 dated 31/03/2008 - residential development)

Decision: 14-07-2011 Approved

10189/APP/2011/1677 Former R A F Eastcote Lime Grove Eastcote

Replacement of one 5 bedroom unit (type 2000D) with an alternative 5 bedroom dwelling at plot 325. (Amendment to reserved matters approval ref: 10189/APP/2007/3046 dated 31/03/2008.

Decision: 06-10-2011 Refused

10189/APP/2011/1724 Former R A F Eastcote Lime Grove Ruislip

Replacement of one 5 Bedroom dwelling (type 2000 D) with an alternative 5 bedroom dwelling at plot 314. (Amendment to reserved matters approval ref: 10189/APP/2007/3046 dated 31/03/2008)

Decision: 25-10-2011 Approved

10189/APP/2011/2278 Former Raf Eastcote Lime Grove Ruislip

3 no additional 2 bedroom apartments within Blocks C and W and re-design of 1 no 1 bedroom apartment within Block V approved under permission ref: 10189/APP/2007/3046

Decision: 10-11-2011 Withdrawn

10189/APP/2011/281 Land At Former R.A.F. Eastcote, Off Eastcote Road High Road East
Provision of glazed conservatory to plot 261: Application to vary parts of the approved layout under Reserved Matters approval ref: 10189/APP/2007/3046 Dated 13/03/2008 (Details of siting, design, external appearance and landscaping in compliance with condition 2 of outline planning permission ref: 10189/APP/2007/3383 Dated 21/02/2008: Residential development.)

Decision: 07-04-2011 Approved

10189/APP/2011/282 Land At Former R.A.F. Eastcote, Off Eastcote Road High Road East
Provision of glazed conservatory to plot 259: Application to vary parts of the approved layout under Reserved Matters approval ref: 10189/APP/2007/3046 Dated 13/03/2008: (Details of siting, design, external appearance and landscaping in compliance with condition 2 of outline planning permission ref: 10189/APP/2007/3383 Dated 21/02/2008: Residential development.)

Decision: 07-04-2011 Approved

10189/APP/2012/106 Former Raf Eastcote Lime Grove Ruislip
Conversion of 3, one bedroom live work units to 6, one bedroom bedroom flats (Block R)

Decision: 30-08-2012 Refused

10189/APP/2012/108 Former Raf Eastcote Lime Grove Ruislip
Conversion of 3 one bedroom live work units to 6, one bedroom flats (Block H1)

Decision: 30-08-2012 Refused

10189/APP/2012/109 Former Raf Eastcote Lime Grove Ruislip
Conversion of 3 one bedroom live work units to 6 x one bedroom flats (Block L)

Decision: 30-08-2012 Refused

10189/APP/2012/112 Former Raf Eastcote Lime Grove Ruislip
Conversion of 3 one bedroom live work units to 6 x one bedroom flats (Block J)

Decision: 30-08-2012 Refused

10189/APP/2012/3144 Former Raf Eastcote Lime Grove Ruislip
S73 Application to vary the external appearance of House Type B (1882) (modifications to conditions 1, 6 and 10 of Reserved Matters approval ref: 10189/APP/2007/3046 dated 13/03/2008: (details of siting, design, external appearance and landscaping), in compliance with conditions 2 and 3 of outline planning permission ref: 10189/APP/2007/3383 Dated 21/02/2008: Residential development).

Decision:

10189/APP/2012/3145 Former Raf Eastcote Lime Grove Ruislip

S73 Application to vary the internal layout and external appearance of House Type P (1761) (modifications to conditions 1, 6 and 10 Reserved Matters approval ref: 10189/APP/2007/3046 dated 13/03/2008: (details of siting, design, external appearance and landscaping), in compliance with conditions 2 and 3 of outline planning permission ref: 10189/APP/2007/3383 Dated 21/02/2008: Residential development.).

Decision:

10189/APP/2012/3146 Former Raf Eastcote Lime Grove Ruislip

S73 Application to vary the internal layout and external appearance of Block D (modifications to conditions 1, 6 and 10 of Reserved Matters approval ref: 10189/APP/2007/3046 dated 13/03/2008: (details of siting, design, external appearance and landscaping), in compliance with conditions 2 and 3 of outline planning permission ref: 10189/APP/2007/3383 Dated 21/02/2008: Residential development).

Decision:

10189/APP/2012/3147 Former Raf Eastcote Lime Grove Ruislip

Section 73 Application to vary the internal layout and external appearance of Block W (modifications to conditions 1, 6 and 10 of Reserved Matters approval ref: 10189/APP/2007/3046 dated 13/03/2008: (details of siting, design, external appearance and landscaping), in compliance with conditions 2 and 3 of outline planning permission ref: 10189/APP/2007/3383 dated 21/02/2008: Residential development).

Decision:

Comment on Relevant Planning History

An enforcement case ENF/350/12 was opened on 4 July 2012 following complaint from a neighbour that an extra rooflight had been inserted in block D, and a dormer in Block C. In November 2012, it came to the Council's attention that there may also be discrepancies with Block W. Further investigation and neighbour complaints highlighted that House Types B & P have not been built in accordance with the approved plans.

The applicant has submitted five concurrent applications, inclusive of the current application, to regularise the breaches at the site.

Outline planning permission was granted on 9th March 2006, for residential development at the former RAF Eastcote site. On February 21st 2008, four separate applications pertaining to the former RAF Eastcote site were considered by the North Planning Committee.

A S73 application to vary this outline planning permission was approved on 21st February 2008 (application ref:10189/APP/2007/3383), to allow flexibility in how vehicular access was to be achieved into the northern portion of the site from Road Eastcote Road. The location and specific details of an alternative access were the subject of a full planning

approval for the necessary works to provide a priority junction and an access link road to the development site utilising the access currently serving the Highgrove House site. (Ref: 10189/APP/2007/2954). This was approved on 3rd March 2008 and has been implemented.

Reserved matters covering details of siting, design, external appearance and landscaping for 385 residential units (ref: 10189/APP/2007/3046) were approved on 31 March 2008. In addition to the reserved matters details, details pursuant to the discharge of various outline planning conditions; namely residential density, community facility, sustainability and energy assessment, refuse and recycling storage, site survey plan, landscaping, and access statements were approved by Committee on 21st February 2008 and have been discharged.

Various applications to vary the layout, design and landscaping of the alternative access scheme approved under reserved matters consent ref:10189/APP/2007/3046, to allow for the provision of conservatories to various plots have subsequently been approved. Details pursuant to the discharge of various outline and reserved matters conditions have also been approved.

4. Planning Policies and Standards

No additional planning policies or standards for consideration.

UDP / LDF Designation and London Plan

The following UDP Policies are considered relevant to the application:-

Part 1 Policies:

- PT1.BE1 (2012) Built Environment
- PT1.EM6 (2012) Flood Risk Management
- PT1.EM7 (2012) Biodiversity and Geological Conservation
- PT1.EM8 (2012) Land, Water, Air and Noise
- PT1.H2 (2012) Affordable Housing

Part 2 Policies:

- AM2 Development proposals - assessment of traffic generation, impact on congestion and public transport availability and capacity
- AM7 Consideration of traffic generated by proposed developments.
- AM8 Priority consideration to pedestrians in the design and implementation of road construction and traffic management schemes
- AM9 Provision of cycle routes, consideration of cyclists' needs in design of highway improvement schemes, provision of cycle parking facilities
- AM13 AM13 Increasing the ease of movement for frail and elderly people and people with disabilities in development schemes through (where appropriate): -
 - (i) Dial-a-ride and mobility bus services
 - (ii) Shopmobility schemes
 - (iii) Convenient parking spaces
 - (iv) Design of road, footway, parking and pedestrian and street furniture schemes

AM14	New development and car parking standards.
BE4	New development within or on the fringes of conservation areas
BE13	New development must harmonise with the existing street scene.
BE15	Alterations and extensions to existing buildings
BE19	New development must improve or complement the character of the area.
BE20	Daylight and sunlight considerations.
BE21	Siting, bulk and proximity of new buildings/extensions.
BE22	Residential extensions/buildings of two or more storeys.
BE23	Requires the provision of adequate amenity space.
BE24	Requires new development to ensure adequate levels of privacy to neighbours.
BE38	Retention of topographical and landscape features and provision of new planting and landscaping in development proposals.
H4	Mix of housing units
H5	Dwellings suitable for large families
OE1	Protection of the character and amenities of surrounding properties and the local area
R16	Accessibility for elderly people, people with disabilities, women and children
R17	Use of planning obligations to supplement the provision of recreation, leisure and community facilities
LPP 3.4	(2011) Optimising housing potential
LPP 3.5	(2011) Quality and design of housing developments
LPP 3.8	(2011) Housing Choice
LPP 5.1	(2011) Climate Change Mitigation
LPP 5.2	(2011) Minimising Carbon Dioxide Emissions
LPP 5.3	(2011) Sustainable design and construction
LPP 5.7	(2011) Renewable energy
LPP 5.12	(2011) Flood risk management
LPP 5.13	(2011) Sustainable drainage
LPP 6.9	(2011) Cycling
LPP 6.13	(2011) Parking
LPP 7.1	(2011) Building London's neighbourhoods and communities
LPP 7.2	(2011) An inclusive environment
LPP 7.3	(2011) Designing out crime
LPP 7.4	(2011) Local character
LPP 7.6	(2011) Architecture
HDAS-LAY	Residential Layouts, Hillingdon Design & Access Statement, Supplementary Planning Document, adopted July 2006
LDF-AH	Accessible Hillingdon , Local Development Framework, Supplementary Planning Document, adopted January 2010
SPD-PO	Planning Obligations Supplementary Planning Document, adopted July 2008

5. Advertisement and Site Notice

5.1 Advertisement Expiry Date:- **6th February 2013**

5.2 Site Notice Expiry Date:- Not applicable

6. Consultations

External Consultees

Site Notice: Erected 16th January 2013.

Press Advertisement: Printed 23rd January.

25 neighbouring occupiers along with the Eastcote and Pembroke Park Residents Associations were notified of the application on 14th January 2013. By the close of the consultation period the Eastcote Residents Association had returned a petition with 33 signatures had been received by the Local Planning Authority. This petition objected to all five concurrent applications as they believe the aggregated effects of all five applications are as follows:

- Loss of Privacy
- Unacceptable Increase in Density across the Scheme

A second petition of 26 residents on Eastcote Road was also received during the consultation period. The signatories on the second petition were not the same as those on the first petition. This neighbouring occupiers also objected to all five applications on the following grounds:

- Loss of Privacy
- Unacceptable Increase in Density across the scheme
- Harm the Character and Appearance of the Eastcote Villages Conservation Area
- Harm to the Appearance of the Approved Building.

The above issues will be discussed in the main body of the report.

Internal Consultees

S106 OFFICER

Having reviewed the completed amendment to the approval I consider that given this is 1 additional bedroom in 1 unit of this block of flats, the impact of any additional population would be de-minimus and therefore no additional planning obligations are required to be secured

CONSERVATION AND URBAN DESIGN

No objection to the changes to the fenestration, dormer and rooflights.

ACCESSIBILITY OFFICER

No accessibility concerns are raised as the amended layout offers an improvement over the plans approved previously.

7. MAIN PLANNING ISSUES

7.01 The principle of the development

The proposed development seeks a S.73 application to regularise the completed development, due to development not being building in accordance with the approved reserved matters plans. An outline of the 'as built' amendment is provided in the proposed development section of this report. All of the proposed amendments are considered not to significantly alter the proposed scheme to an extent where a new consent would be required. Therefore, the use of a S.73 application in this instance is considered

acceptable.

7.02 Density of the proposed development

A number of neighbouring occupiers have objected to the proposed development on the grounds on an unacceptable increase in density across the site. This application forms one of five concurrent application and the neighbouring occupier have objected to the accumulative impact on density from all five application.

The completed development has created a three bedroom flat at second floor level within Block C, which was approved to be a 2 bedroom flat at reserved matters stage. The creation of an additional bedroom within a 385 unit scheme is considered to have an acceptable impact on the overall residential densities of the scheme.

Across the five applications there has been a no additional residential units created and two bedrooms and two studies, totaling four habitable rooms, have been added across the whole site. The addition of four habitable rooms across a 385 unit scheme is not considered to increase the residential density to an unacceptable level. Therefore, no objection is raised in regard to the impact on the density of the scheme.

7.03 Impact on archaeology/CAs/LBs or Areas of Special Character

The boundary of the Eastcote Villages Conservation Area is the shared boundary line between the application site and the curtilages of Nos. 1 - 3 New Cottages, with the application site falling outside of the conservation area. Policy BE4 of the Hillingdon Local Plan Part 2 requires development on the fringes of a Conservation Area to preserve or enhance the character and appearance of the area.

The only elevation of the building that is visible from the Conservation Area is the northeast side elevation. The minor alteration which to this flank has been the opening up of the eaves below the dormer. The harm from this minor deviation from the approval is considered not to be so great to the character and appearance of the Conservation Area to be unacceptable. Therefore, the completed amendment is considered to comply with Policy BE4 of the Hillingdon Local Plan.

7.04 Airport safeguarding

The completed building has not increased in above the height approved in the reserved matters application. Therefore, no objection is raised on airport safeguarding grounds.

7.05 Impact on the green belt

Not applicable to this application.

7.06 Environmental Impact

Not applicable to this application.

7.07 Impact on the character & appearance of the area

The applicant seeks approval to regularise a number of alterations to the building which were not part of the outline consent. The completed amendments relate to the increase in the size of rooflights to accord with building regulations, the insertion of additional rooflights into the side roof slope of the building and amendments to the design of the dormers. These minor alterations are considered not be so harmful to the visual amenities of the surrounding area to be unacceptable and the application is considered to comply with Policies BE13, BE15 & BE19 of the Hillingdon Local Plan Part 2 Policies.

7.08 Impact on neighbours

The amendments proposed in this application has not increased the height or siting of the building. Therefore, the completed building is considered not to have cause significant harm of the residential amenity of any neighbouring occupier in terms of loss of light, loss of outlook or sense of dominance.

The building has been completed with three additional rooflights in the southern elevation facing towards the estate road and an enlarged window on the western roofslope facing in towards the site. The additional and enlarged fenestration is not within 21 metres of any existing dwelling and is considered not to cause harm to any neighbouring occupier in terms of loss of privacy. Therefore, the proposed development is considered to comply with Policies BE20, BE21 & BE24 of the Hillingdon Local Plan Part 2 Policies.

7.09 Living conditions for future occupiers

INTERNAL FLOOR AREA

The internal alterations to the second floor flat within Block C has increased the size of this flat from 2 bedroom to 3 bedrooms. Policy 3.5 of the London Plan (July 2011) requires a three bedroom flat (4 person) to be provided with 74 square metres of internal floor area. The flat has been completed with an internal floor area of 107 square metres in accordance with Policy 3.5 of the London Plan (July 2011).

EXTERNAL AMENITY SPACE

The increase in the second floor flat from two bedroom to three bedroom would require an additional 5 square metres of external amenity space to meet the requirements of the HDAS Residential Layouts. The existing flat block is well served with amenity space around the building and the creation of an additional bedroom within the block is considered not to place an unacceptable burden on the amenity space which services block C.

7.10 Traffic impact, Car/cycle parking, pedestrian safety

CAR PARKING

The Adopted Car Parking Standards requires a two or three bedroom dwelling to provide the same maximum standard of 1.5 spaces per dwelling. Therefore, no objection is raised to the increase in the second floor flat from two bedrooms to three bedrooms as the parking levels would remain adequate and in compliance with the Adopted Car Parking Standards

CYCLE PARKING

Block C would have an integral cycle store with space for 10 cycles. The built development has provided 2 x 1 bedroom flats, 6 x 2 bedroom flats and 1 x 3 bedroom flat, with the adopted Cycle Standards requiring 10 cycle spaces to service the 9 flats. Therefore, the proposal is in accordance with the adopted Cycle Standards and Policy 6.9 of the London Plan (July 2011).

7.11 Urban design, access and security

The completed development has not increased the height of the building or enlarged the footprint above that of the reserved matters approval. The additional windows are considered proportionate to the building and have an acceptable impact on the appearance of the surrounding area.

7.12 Disabled access

The amended internal has been reviewed by the Accessibility Officer who believes the amended layout is an improvement in accessibility terms. Therefore, the completed development is considered to comply with Lifetime Homes Standards and Policy AM13 of the Hillingdon Local Plan (July 2011).

7.13 Provision of affordable & special needs housing

Not applicable to this application.

7.14 Trees, landscaping and Ecology

Not applicable to this application.

7.15 Sustainable waste management

Not applicable to this application.

7.16 Renewable energy / Sustainability

Not applicable to this application.

7.17 Flooding or Drainage Issues

Not applicable to this application.

7.18 Noise or Air Quality Issues

Not applicable to this application.

7.19 Comments on Public Consultations

No further comments in relation to the Public Consultation.

7.20 Planning obligations

The s.106 officer has reviewed the proposal and considers the addition of 1 bedroom to the scheme to be 'de minimis' and no additional contribution towards educational facilities is sought.

7.21 Expediency of enforcement action

No further action required in relation to the breaches of condition being regularised by this application.

7.22 Other Issues

None received.

8. Observations of the Borough Solicitor

None received

9. Observations of the Director of Finance

None received.

10. CONCLUSION

The completed development is considered to have had an acceptable impact on the visual amenities of the surrounding area and the character and appearance of the Eastcote Village Conservation Area. The additional rooflights in Block C are considered not to have led to a significant loss of residential amenity to any neighbouring occupier in terms of loss of privacy.

The enlarged second floor flat is provided with sufficient internal floor area and external amenity area for a three bedroom flat and the amended layout is considered accessible by wheelchair users. Therefore, the application is recommended for approval.

11. Reference Documents

The Hillingdon Local Plan.

The London Plan (July 2011).

National Planning Policy Framework.

Hillingdon Design and Accessibility Statement Accessible Hillingdon.

Contact Officer: Alex Smith

Telephone No: 01895 250230

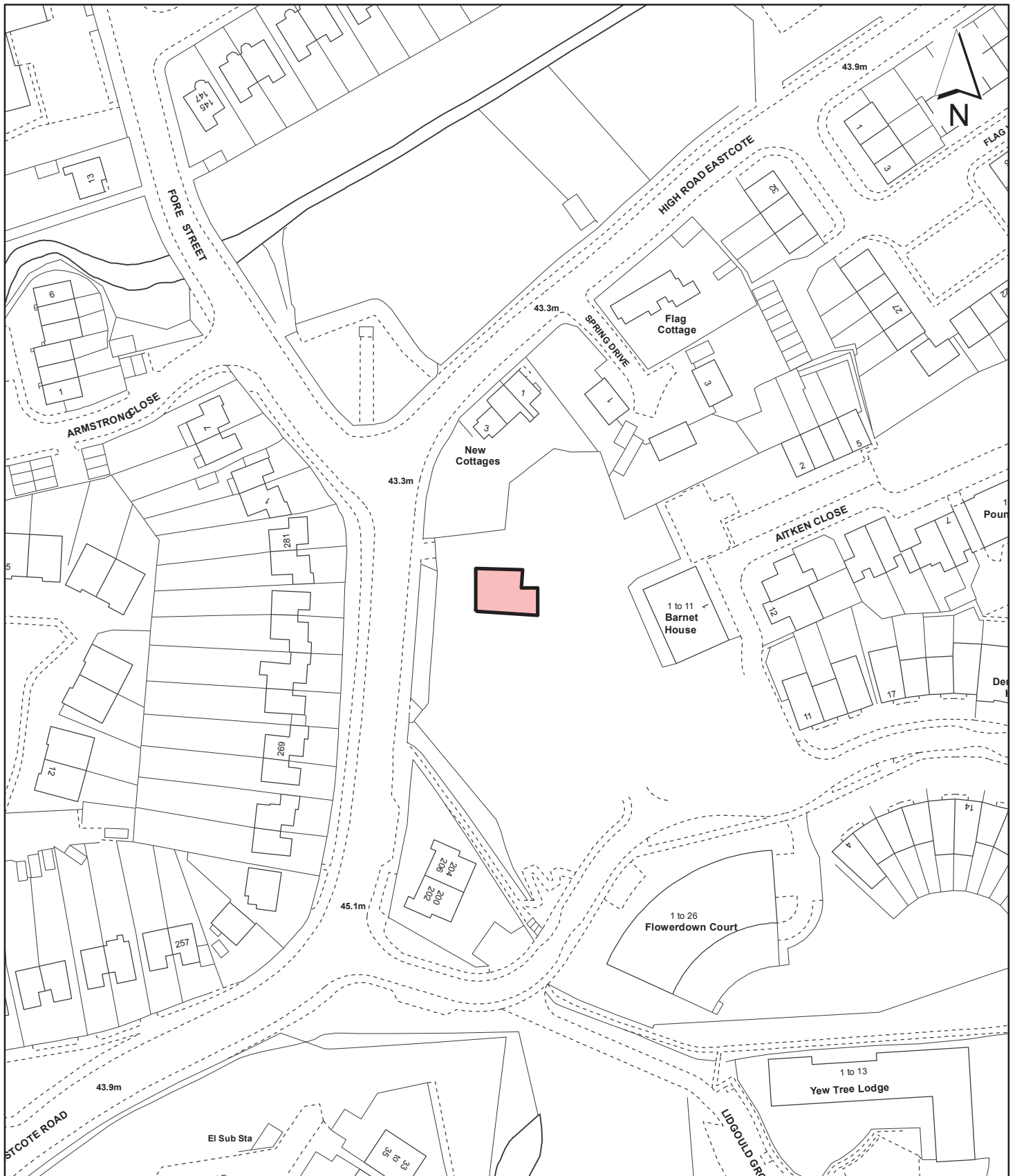

Notes

 Site boundary

For identification purposes only.

This copy has been made by or with the authority of the Head of Committee Services pursuant to section 47 of the Copyright, Designs and Patents Act 1988 (the Act). Unless the Act provides a relevant exception to copyright.

© Crown copyright and database rights 2013 Ordnance Survey 100019283

Site Address

**Former RAF Eastcote
Lime Grove
Ruislip**

**LONDON BOROUGH
OF HILLINGDON
Residents Services**

Civic Centre, Uxbridge, Middx. UB8 1UW
Telephone No.: Uxbridge 250111

Planning Application Ref:

10189/APP/2012/3143

Scale

1:1,250

Planning Committee

North

Date

**February
2013**



HILLINGDON
LONDON